

TECHNICAL SPECIFICATIONS

BEFORE ORDERING PLEASE NOTE:

75% of all kitchens ordered have insufficient quantities of plinth, cornice/pelmet and accessory panels.

Please double check your requirements allowing sufficient extra lengths to cover joints, mitres, shapings etc. Failure to do so may delay your installation.

KEY



NOTE:

Measurements are in millimetres.

Not all units shown are available in every range.

Inside stacked wall units and bridging units under cupboard lights should be used instead of low voltage downlights.

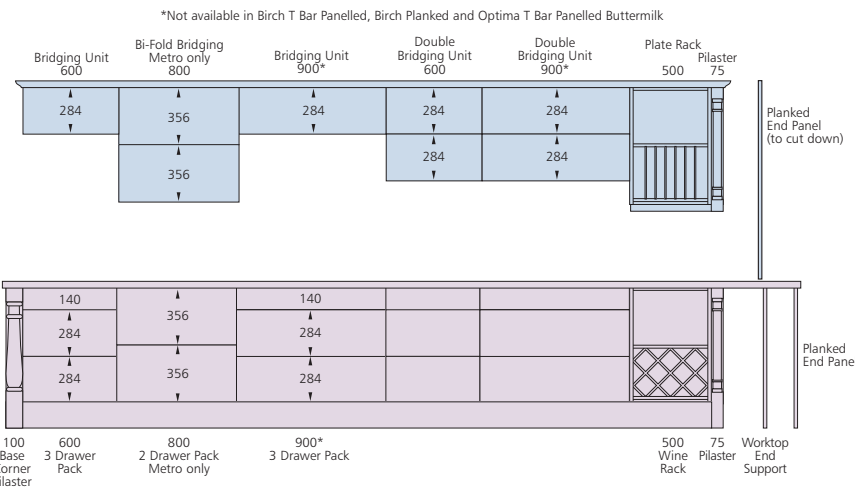
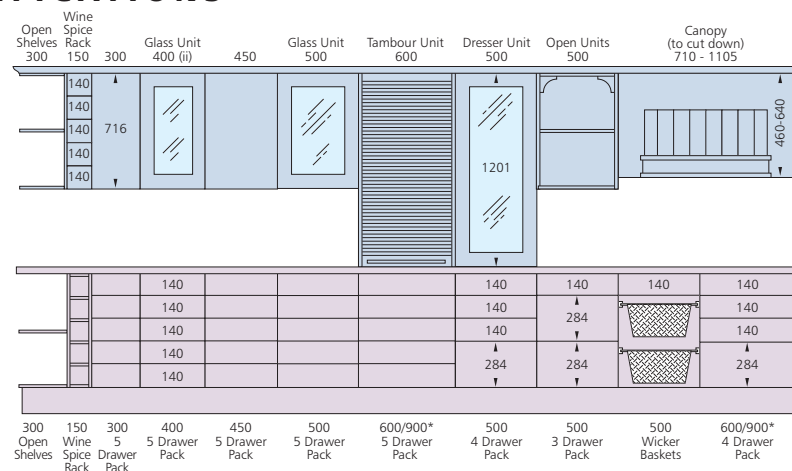

(ii) Not available in:
Shaker Honey
Harvard
Alto
Shaker Birch
Shaker Light Oak
Birch Planked

(iii) Not available in:
Gullwing Natural Oak and Walnut
Moderna Honey, Gloss White and Buttermilk
Shaker Maple, Beech and Honey
Profile Honey Shaker
Alto
Optima T Bar
Optima Buttermilk
Evolution Maple
Shaker Light Oak
Shaker Beechwood
Birch T Bar Panelled
Birch Reed
Stratford Oak
Shaker Maplewood
Shaker Beechwood

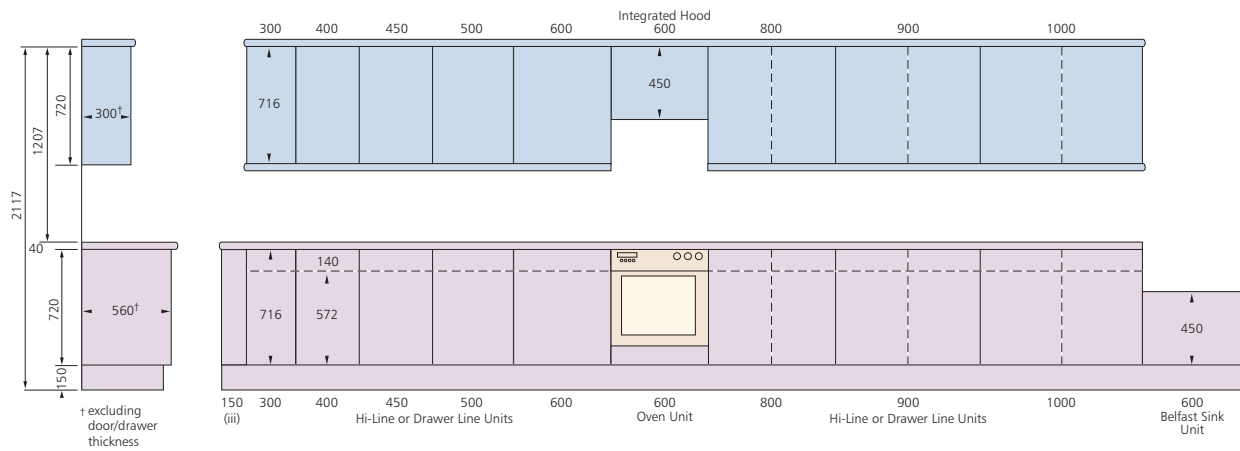

Corner units

If your new kitchen plan includes a corner unit this should always be fitted first. Please note the corner unit positioning and spacing in the guide shown right.

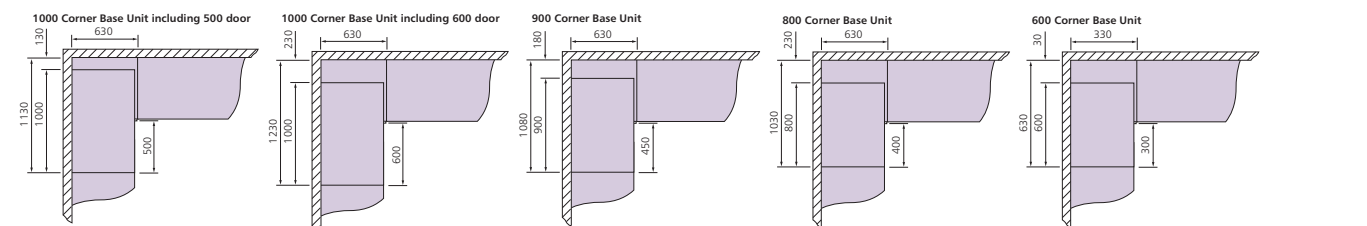
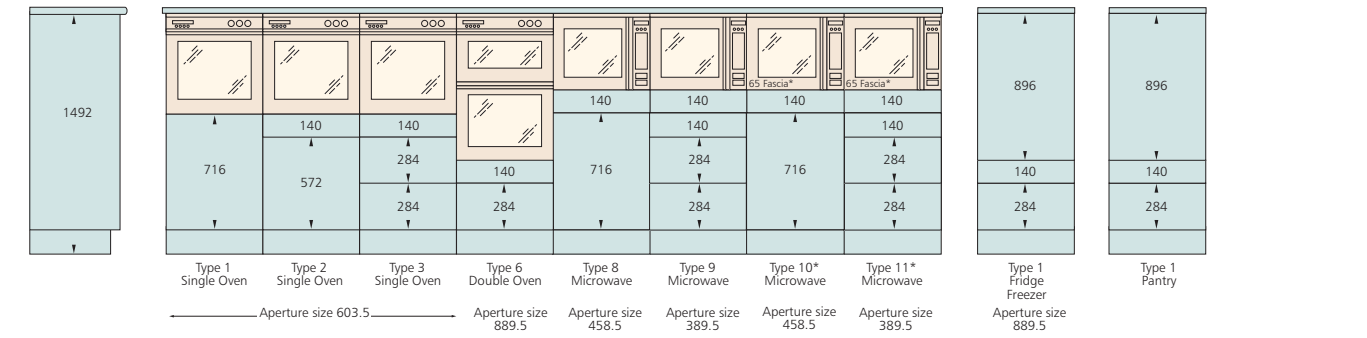
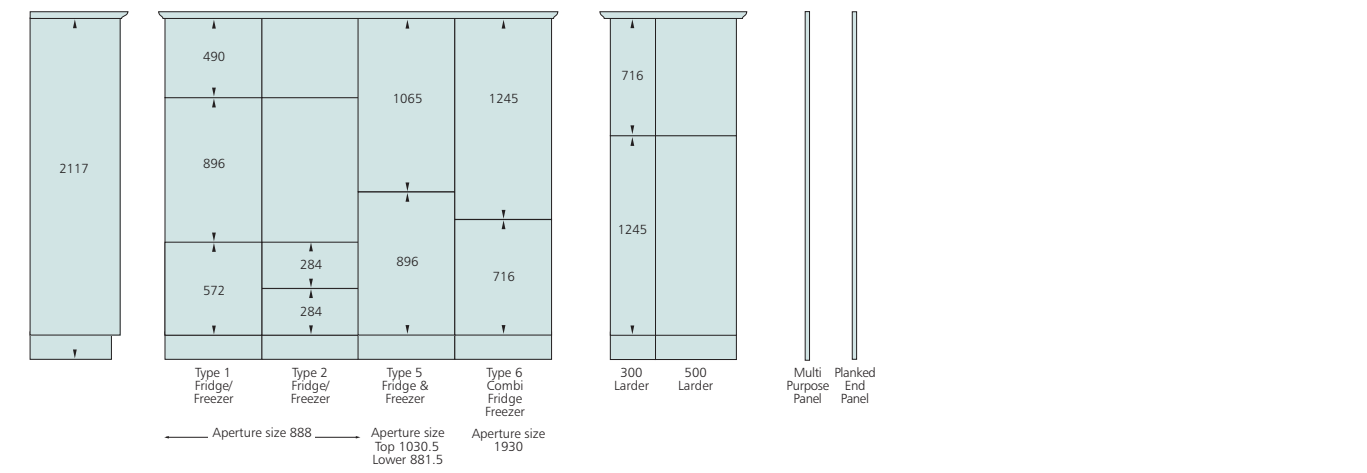
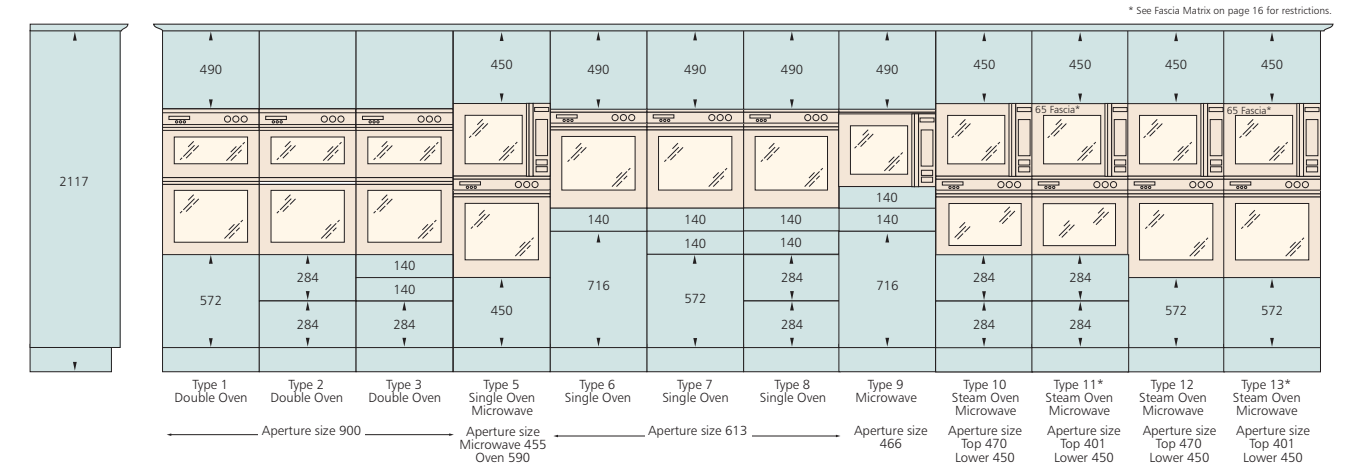
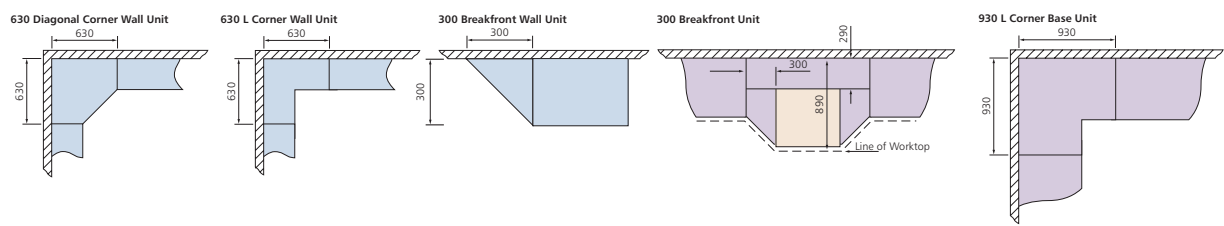

* See Fascia Matrix on page 16 for restrictions.